

# SRP - 770

---

## Thermal Label Printer Operator's Manual

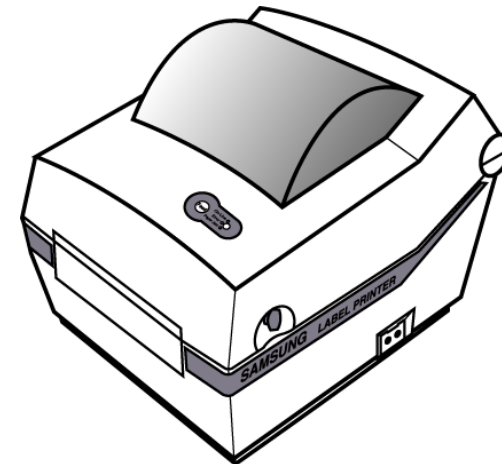











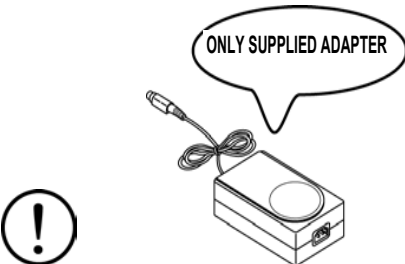

**JE68-00131B**

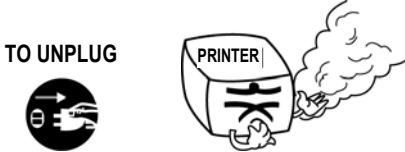
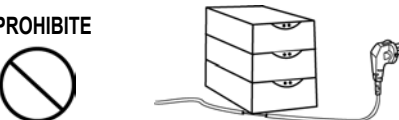
<http://www.samsungminiprinters.com>

# Safety Precautions

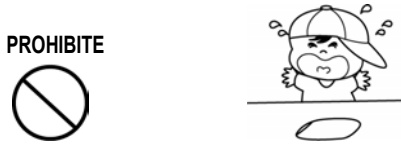
In using the present appliance, please keep the following safety regulations in order to prevent any hazard or material damage.

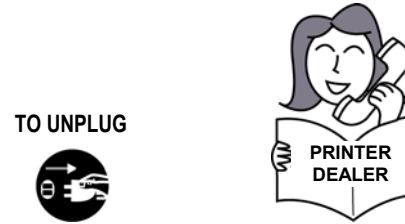
 <b>WARNING</b> Violating following instructions can cause serious injury or death.	
<p>Do not plug several products in one multi-outlet.</p> <ul style="list-style-type: none"> <li>This can provoke over-heating and a fire.</li> <li>If the plug is wet or dirty, dry or wipe it before usage.</li> <li>If the plug does not fit perfectly with the outlet, do not plug in.</li> <li>Be sure to use only standardized multi-outlets.</li> </ul>	<p>You must use only the supplied adapter.</p> <ul style="list-style-type: none"> <li>It is dangerous to use other adapters.</li> </ul>
<p><b>PROHIBITE</b></p> 	<p><b>ONLY SUPPLIED ADAPTER</b></p> 
<p>Do not pull the cable to unplug.</p> <ul style="list-style-type: none"> <li>This can damage the cable, which is the origin of a fire or a breakdown of the printer.</li> </ul>	<p>Keep the plastic bag out of children's reach.</p> <ul style="list-style-type: none"> <li>If not, a child may put the bag on his head.</li> </ul>
<p><b>PROHIBITE</b></p> 	<p><b>PROHIBITE</b></p> 
<p>Do not plug in or unplug with your hands wet.</p> <ul style="list-style-type: none"> <li>You can be electrocuted.</li> </ul>	<p>If you observe a strange smoke, odor or noise from the printer, unplug it before taking following measures.</p> <ul style="list-style-type: none"> <li>Switch off the printer and unplug the set from the mains.</li> <li>After the disappearance of the smoke, call your dealer to repair it.</li> </ul>
<p><b>PROHIBITE</b></p> 	<p><b>TO UNPLUG</b></p> 
<p>Do not bend the cable by force or leave it under any heavy object.</p> <ul style="list-style-type: none"> <li>A damaged cable can cause a fire.</li> </ul>	
<p><b>PROHIBITE</b></p> 	

 <b>WARNING</b> Violating following instructions can cause slight wound or damage the appliance.	
<p>Keep the desiccant out of children's reach.</p> <ul style="list-style-type: none"> <li>If not, they may eat it.</li> </ul>	<p>Install the printer on the stable surface.</p> <ul style="list-style-type: none"> <li>If the printer falls down, it can be broken and you can hurt yourself.</li> </ul>
<p><b>PROHIBITE</b></p> 	<p><b>PROHIBITE</b></p> 
<p>Use only approved accessories and do not try to disassemble, repair or remodel it for yourself.</p> <ul style="list-style-type: none"> <li>Call your dealer when you need these services.</li> </ul>	<p>Do not use the printer when it is out of order. This can cause a fire or an electrocution.</p> <ul style="list-style-type: none"> <li>Switch off and unplug the printer before calling your dealer.</li> </ul>
<p><b>DISASSEMBLING PROHIBITED</b></p> 	<p><b>TO UNPLUG</b></p> 
<p>Do not let water or other foreign objects in the printer.</p> <ul style="list-style-type: none"> <li>If this happened, switch off and unplug the printer before calling your dealer.</li> </ul>	
<p><b>PROHIBITE</b></p> 	

# 1. Unpacking

Your printer box should include these items. If any items are damaged or missing, please contact your dealer for assistance.

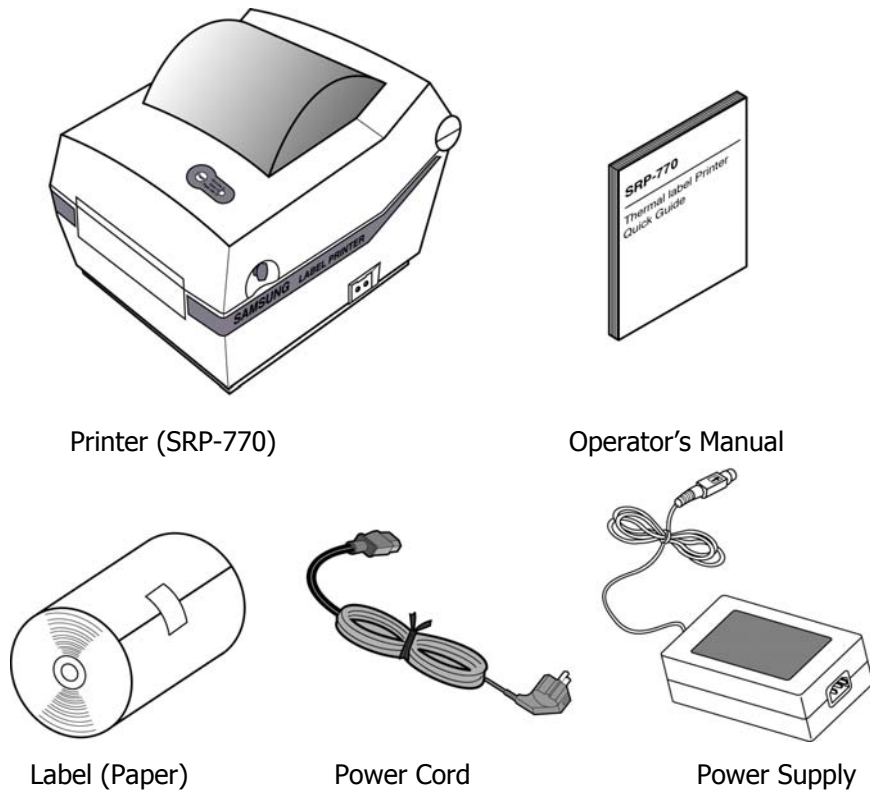

# 2. Samsung Label Printer

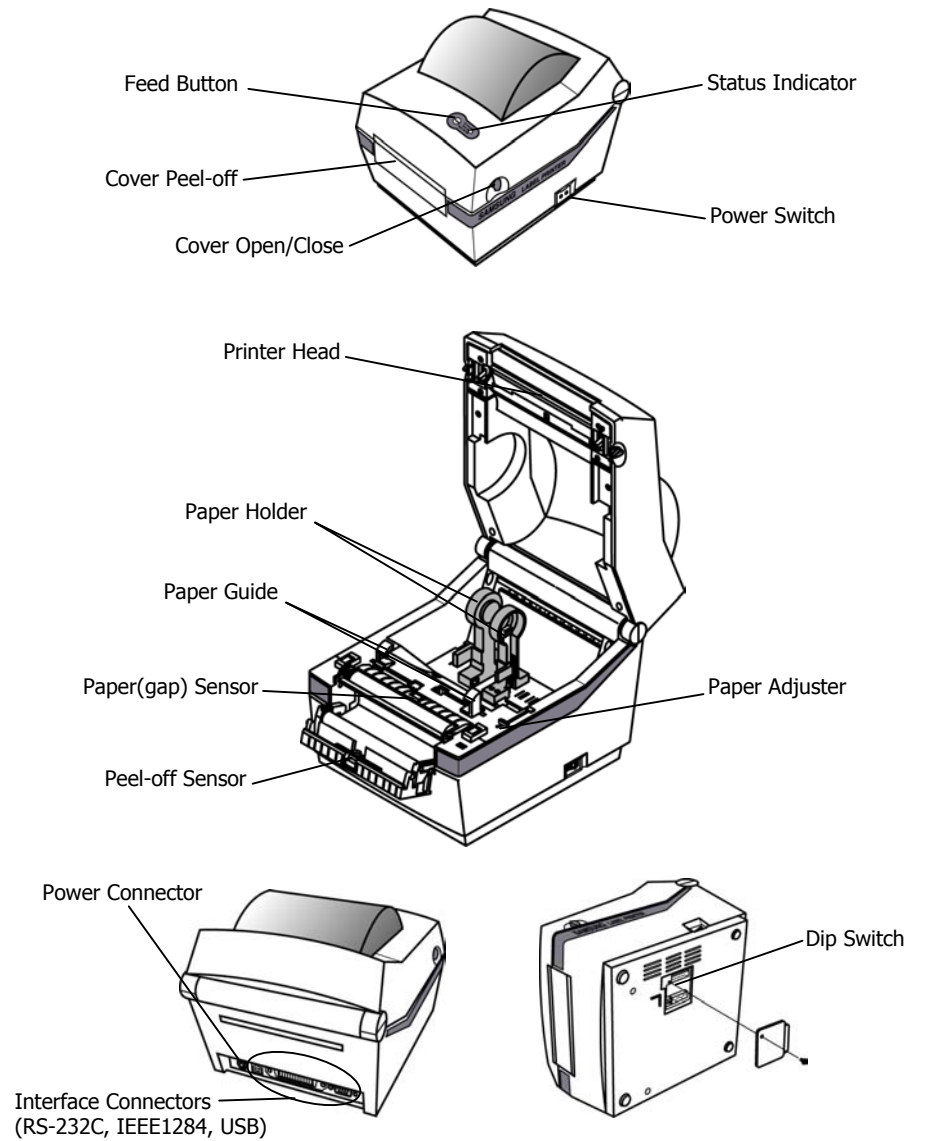

### 3. Connecting the Power Supply

**CAUTIONS:**

When connecting or disconnecting the power supply from the printer, make sure that the power supply is not plugged into an electrical outlet. And the power supply's rated voltage and your outlet's voltage do not match, contact your dealer for assistance. Then do not plug in the power cord. Otherwise, you may damage the power supply or the printer.

1. Make sure that the printer's power switch is turned off, and the power supply's power cord is unplugged from the electrical outlet.
2. Check the label on the power supply to make sure that the voltage required by the power supply matches that of your electrical outlet.
3. Plug in the power supply's cable as shown below. Notice that the flat side of the plug faces down.

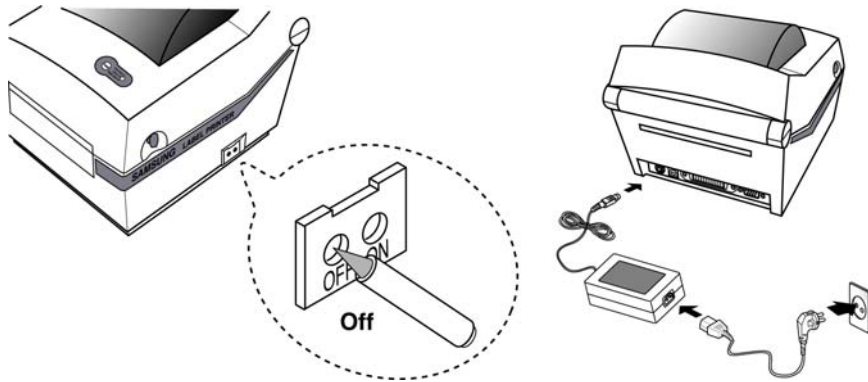

### 4. Connecting the Interface Cable

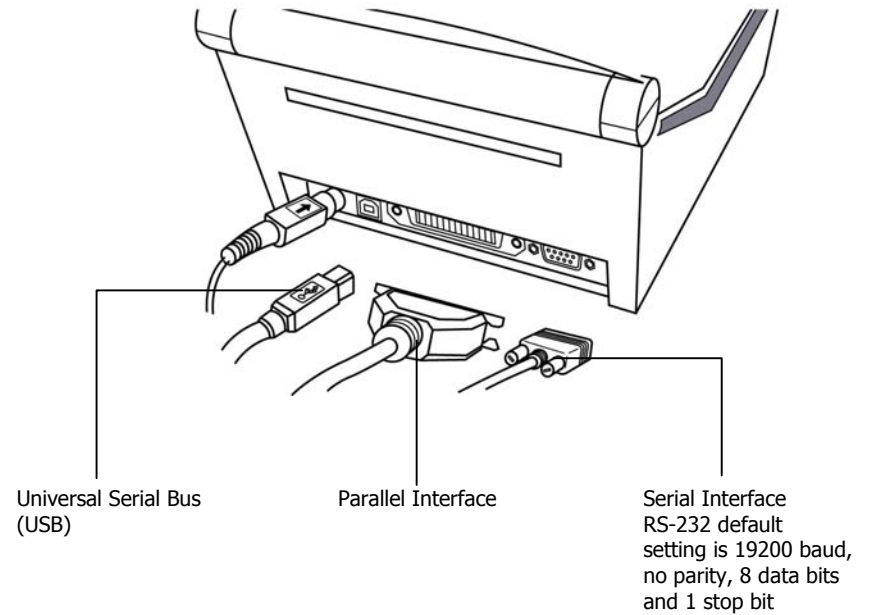

**\* Note**  
Defaultly, you can use Serial and Parallel Interface.  
If you want to use **USB** Interface, please turn on the **Dip S/W2-4**

## 5. Installing or Replacing the Paper Roll

① Open Cover

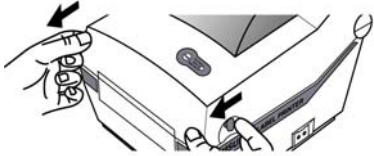

② Open Guides

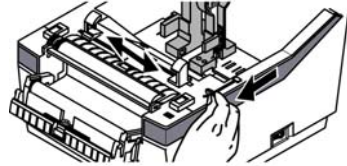

③ Install Roll

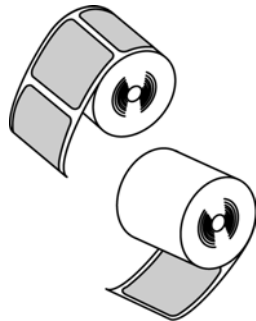
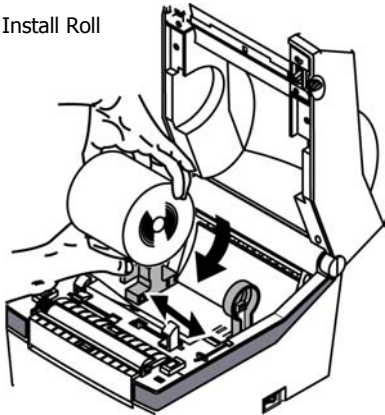

④ Close Guides to the Width of the paper



⑤ Close Cover



## 6. Setting The Dip Switches

### 6-1. Setting the Dip Switches

The Dip Switches are located on the bottom of the printer. The Dip Switches are used to set the Printer to perform various functions. Follow these steps when changing Dip Switches setting :

1. Turn the printer power switch off.
2. Remove the screw on the bottom of the printer and open the bracket.
3. Flip the Dip Switches using tweezers or another narrow-ended tool. Switches are **off** when up and **on** when down in the Figure below.
4. The new setting takes effect when you turn on the printer.

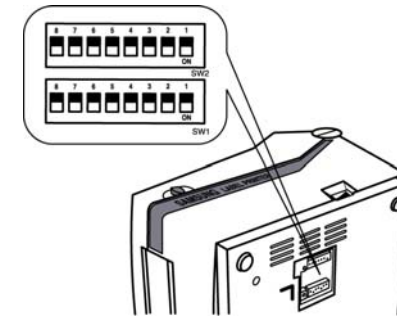

**Note :** Always change Dip Switch settings only when the printer is turned off.

### 6-2. Functions of Dip Switches

6-2-1. Dip S/W 1

NO	Functions	Details		
		2	1	Speed
1,2	Speed Selection	Off	Off	2.5 ips
		Off	On	3.0 ips
		On	Off	4.0 ips
		On	On	5.0 ips
		4	3	Density
3,4	Density Selection	Off	Off	0(Low)
		Off	On	7
		On	Off	13
		On	On	20(High)
5,6,7	Developer Mode	Default --- off		
8	Position Selection	Off	Move to Cutting Position	
		On	Move to top of next page	

6-2-2. Dip S/W 2

No	Functions	Details		
		2	1	Baud Rate
1,2	Baud Rate	Off	Off	9,600 bps
		Off	On	19,200 bps
		On	Off	57,600 bps
		On	On	115,200 bps
		3	Flow Control	Off
4	Interface Selection	On	RTS/CTS	
		Off	Serial & Parallel	
5~8	Developer Mode	On	Serial & USB	
		Default --- off		

## 7. The Self Test (and Autosense Gapsensor Adjustment)

The self-test checks whether the printer has any problems. And perform this procedure when loading a new roll. (You cannot perform this procedure if using the printer's label peel-off option) If the printer does not function properly, contact your dealer. The self-test checks the following;

1. Make sure that paper roll has been installed properly.
2. Turn on the power while holding (2sec) down the FEED button. The self-test begins.
3. The self-test prints the current printer status, which provides the control ROM version and the DIP switch setting.

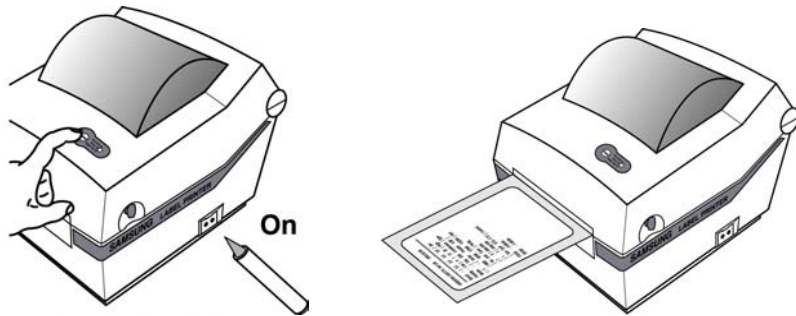

### ※ Cleaning Head

Paper dust on the heating elements may lower the printer quality. In this case, clean the print head as follows :

- Cautions**
1. Turn Off the printer power before cleaning.
  2. Note that the thermal head becomes very hot during normal operation, creating the danger of burn injury. Be sure to wait for about 10 minutes after turning printer power off before beginning the cleaning.

1. Open the printer cover.
2. Clean the thermal element (the area which is marked a thin black line) of the thermal head with a cotton swab moistened with an alcohol solvent (ethanol, methanol, or IPA).
3. After confirming that the alcohol solvent has been dried up completely, close the cover-open.

- Note**
1. **Never touch the thermal element with your hand, then the thermal element can be damaged.**
  2. **Don't scratch the printer head.**

## 8. The Peel-off

Printers can Peel-off a single label.  
You must remove the label before the printer prints the next label.

- ① Open the peel-off cover and turn on peeler switch.

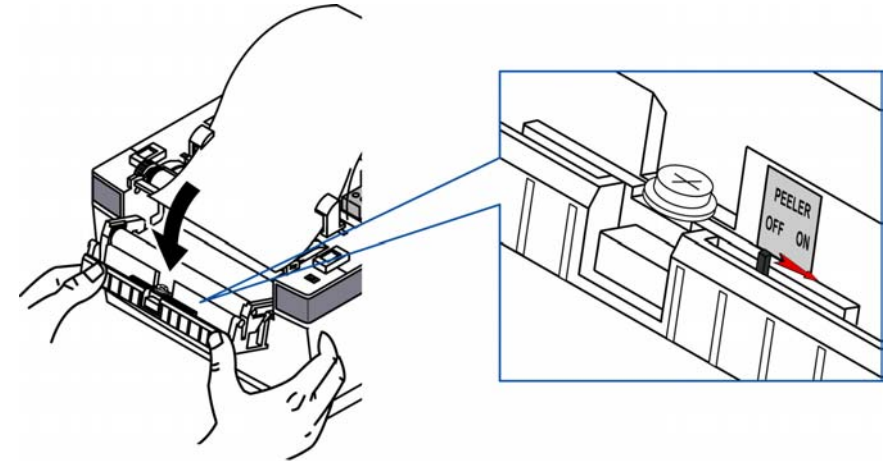

- ② Remove the one a paper and insert the paper through slot.
- ③ Adjust the paper guides and close the cover.

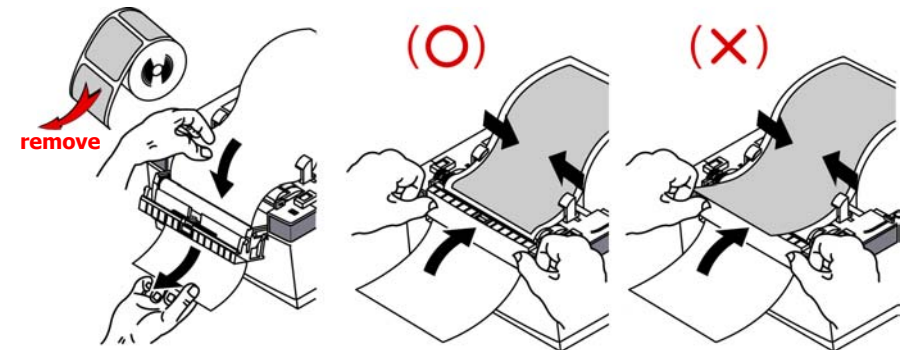

# 9. Using Fan Fold Paper

Insert paper through both the rear slot and guides.  
Adjust holders and guides to the width of the paper.

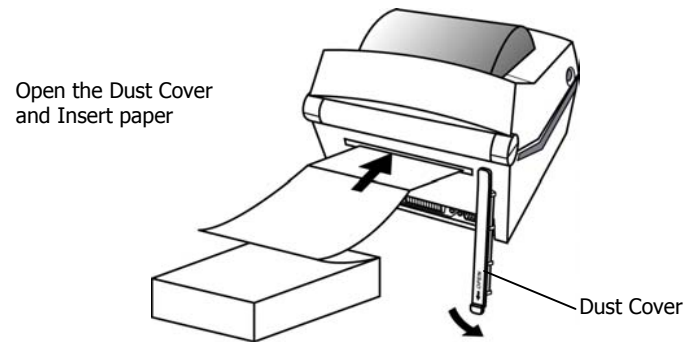

Open the Dust Cover  
and Insert paper

Dust Cover

Adjust holders papers and paper Fixed

Adjust Guides

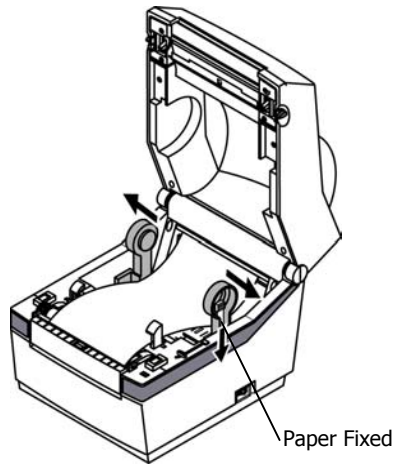

Paper Fixed

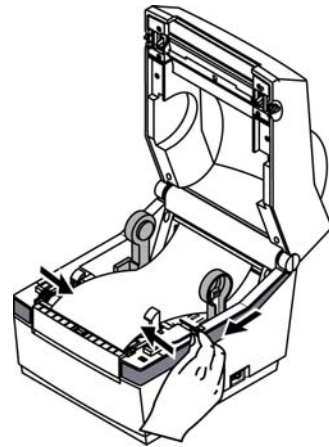

## 【 Specification 】

<b>Printing method</b>	Thermal line printing	
<b>Dot density</b>	203 dpi (8 dot/mm)	
<b>Printing width</b>	25.4 ~ 101.6 mm	
<b>Paper width</b>	38.1 ~ 104 mm	
<b>Printing speed</b>	127 mm/sec	
<b>Receive Buffer Size</b>	4K Byte	
* <b>Note</b> : Printing speed may be slower, depending on the data transmission speed and the combination of control commands.		
<b>Supply voltage</b>	<b>Input voltage</b>	100~240V AC
	<b>Frequency</b>	50/60 Hz
	<b>Output voltage</b>	DC 24V
<b>Environmental conditions</b>	<b>Temperature</b>	5 ~ 45 °C (Operating) -25 ~ 70 °C (Storage)
	<b>Humidity</b>	30 ~ 80 % RH (Operating) 10 ~ 90 % RH (Storage) ; Except for paper
<b>LIFE</b>	<b>Mechanism Head</b>	10,000,000 lines 5 × 10 <sup>7</sup> pulse (50km)
<b>MCBF</b>	<b>Mechanism</b>	20,000,000 lines